

FOR LEASE 45,525 SQ. FT.

2050 Nut Tree Road, Vacaville, CA

CAN SUBDIVIDE



PROPERTY HIGHLIGHTS

- Excellent Demographics
- Rare in Fill Location
- Zoning: CN (Neighborhood Commercial)
- 377.81 Feet of Frontage on Elmira Road
- Premier Location
- Ideally Located for Grocer, Drug & Big Box Retail
- Excellent Visibility and Parking
- Dock, High Loading Dock

Demographics (2009 EST.):

| | 1 Mile | 3 Miles | 5 Miles |
|----------------|----------|----------|----------|
| Population | 22,295 | 84,642 | 101,939 |
| Med. Household | \$73,624 | \$71,410 | \$73,586 |

Traffic Counts:

| | |
|---------------|-------------|
| Elmira Road | ±18,000 ADT |
| Nut Tree Road | ±15,600 ADT |



Terrence Tallen

415-905-8840

info@retailenterprise.net

License # 01432203

RETAIL ENTERPRISE GROUP, INC.
Your Value Creation Resource

The information contained herein was obtained from sources believed reliable; however, Retail Enterprise Group, Inc. makes no guarantees, warranties, or representations as to the completeness or accuracy thereof.

FOR LEASE 45,225 sq. ft. 2050 Nut Tree Road, Vacaville, CA

RARE IN FILL LOCATION



RETAIL ENTERPRISE GROUP, INC

Terrence Tallen

415-905-8840

info@retailenterprisegroup.net

License # 01432103

The information contained herein was obtained from sources believed reliable; however, Retail Enterprise Group, Inc. makes no guarantees, warranties, or representations as to the completeness or accuracy thereof.

FOR LEASE 45,525 SQ. FT.

2050 Nut Tree Road, Vacaville, CA

EXCELLENT DEMOGRAPHICS

Shopping Center Site Plan

Fresh & Easy and CVS have recently opened directly across the street on Elmira.

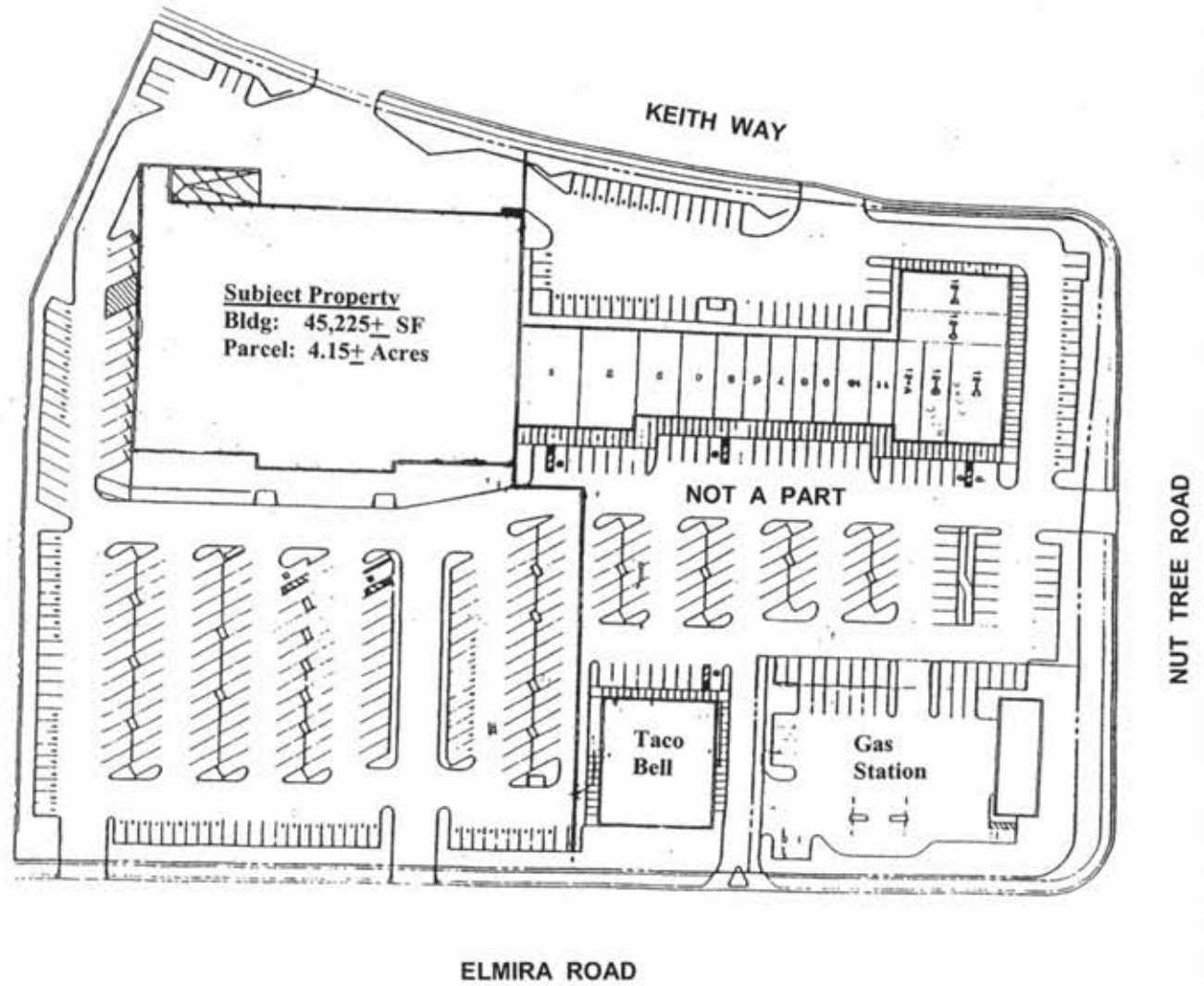

RETAIL ENTERPRISE GROUP, INC

Terrence Tallen

415-905-8840

info@retailenterprise.net

License # 01432103

The information contained herein was obtained from sources believed reliable; however, Retail Enterprise Group, Inc. makes no guarantees, warranties, or representations as to the completeness or accuracy thereof.

US Census 2000 Overview Comparison

Geography: 1 Mile: 2050 NUT TREE RD VACAVILLE, CA 95687, 3 Miles: 2050 NUT TREE RD VACAVILLE, CA 95687, 5 Miles...

| | 1 Mile: 2050 NUT TREE RD VACAVILLE, CA 95687 | 3 Miles: 2050 NUT TREE RD VACAVILLE, CA 95687 | 5 Miles: 2050 NUT TREE RD VACAVILLE, CA 95687 |
|---------------------------------------|---|--|--|
| Basic Variables | | | |
| Population | 21,437 | 77,294 | 94,288 |
| Female Population | 10,727 | 36,856 | 43,338 |
| Female Percentage | 50.0% | 47.7% | 46.0% |
| Male Population | 10,710 | 40,438 | 50,950 |
| Male Percentage | 50.0% | 52.3% | 54.0% |
| Households | 7,289 | 25,933 | 30,216 |
| Age: Total | | | |
| Age 0 to 4 | 7.0% | 7.0% | 6.6% |
| Age 5 to 9 | 9.0% | 8.2% | 7.7% |
| Age 10 to 13 | 7.8% | 6.7% | 6.5% |
| Age 14 to 17 | 7.7% | 6.4% | 6.2% |
| Age 18 to 20 | 4.3% | 3.8% | 3.8% |
| Age 21 to 24 | 4.8% | 5.1% | 5.2% |
| Age 25 to 29 | 6.9% | 7.2% | 7.2% |
| Age 30 to 34 | 7.0% | 8.8% | 8.7% |
| Age 35 to 39 | 9.7% | 9.3% | 9.5% |
| Age 40 to 44 | 9.4% | 9.3% | 9.6% |
| Age 45 to 49 | 7.8% | 7.2% | 7.5% |
| Age 50 to 54 | 6.0% | 5.7% | 6.2% |
| Age 55 to 59 | 3.8% | 4.0% | 4.2% |
| Age 60 to 64 | 2.6% | 2.8% | 2.9% |
| Age 65 to 69 | 2.1% | 2.6% | 2.6% |
| Age 70 to 74 | 1.5% | 2.1% | 2.0% |
| Age 75 to 79 | 1.2% | 1.8% | 1.8% |
| Age 80 to 84 | 0.8% | 1.2% | 1.2% |
| Age 85 Plus | 0.5% | 0.9% | 0.8% |
| Median Age | 31.8 | 33.2 | 34.0 |
| Educational Attainment | | | |
| No schooling completed | 0.5% | 1.6% | 1.9% |
| School: PreK to 8 | 2.4% | 3.4% | 3.1% |
| School: 9th to 11th grade, no diploma | 6.3% | 10.3% | 11.0% |
| School: High school graduate | 24.3% | 25.7% | 25.4% |
| College: Associate degree | 10.4% | 9.7% | 9.3% |
| College: Some college, no degree | 33.6% | 30.4% | 29.7% |
| College: Bachelor's degree | 15.4% | 12.8% | 12.9% |
| College: Graduate degree | 7.1% | 6.3% | 6.8% |

Race & Ethnicity

| | | | |
|--|-------|-------|-------|
| American Indian and Alaska Native Alone | 0.9% | 1.0% | 1.0% |
| Asian Alone | 4.5% | 4.3% | 4.4% |
| Black Alone | 7.9% | 9.3% | 9.9% |
| Native Hawaiian and Other Pacific Islander Alone | 0.4% | 0.5% | 0.5% |
| Some Other Race Alone | 5.6% | 7.0% | 6.6% |
| Two or More Races | 6.5% | 5.9% | 5.5% |
| White Alone | 74.3% | 72.2% | 72.1% |
| Hispanic or Latino | 14.5% | 18.1% | 17.7% |
| Not Hispanic or Latino | 85.5% | 81.9% | 82.4% |

Income by Type: Household Income

| | | | |
|--------------------------|----------|----------|----------|
| Less than \$10,000 | 3.1% | 4.2% | 4.1% |
| \$10,000 to \$14,999 | 3.0% | 3.9% | 3.6% |
| \$15,000 to \$19,999 | 3.5% | 4.2% | 3.9% |
| \$20,000 to \$24,999 | 4.0% | 5.1% | 4.8% |
| \$25,000 to \$29,999 | 4.7% | 5.0% | 4.9% |
| \$30,000 to \$34,999 | 4.6% | 5.2% | 5.0% |
| \$35,000 to \$39,999 | 5.1% | 5.3% | 5.1% |
| \$40,000 to \$44,999 | 6.4% | 6.1% | 5.7% |
| \$45,000 to \$49,999 | 5.4% | 5.6% | 5.4% |
| \$50,000 to \$59,999 | 10.6% | 9.4% | 9.2% |
| \$60,000 to \$74,999 | 14.6% | 14.1% | 14.1% |
| \$75,000 to \$99,999 | 18.1% | 16.0% | 16.6% |
| \$100,000 to \$124,999 | 8.1% | 7.9% | 8.7% |
| \$125,000 to \$149,999 | 4.6% | 3.6% | 4.2% |
| \$150,000 to \$199,999 | 3.2% | 3.2% | 3.4% |
| \$200,000 or more | 1.1% | 1.2% | 1.6% |
| Median Household Income | \$59,568 | \$55,624 | \$58,275 |
| Per Capita Income | \$22,592 | \$21,324 | \$21,194 |
| Average Household Income | \$66,444 | \$63,555 | \$66,137 |

Size of Household

| | | | |
|-----------------------|-------|-------|-------|
| 1 Person Households | 17.3% | 19.9% | 19.0% |
| 2 Person Households | 29.8% | 30.4% | 31.1% |
| 3 Person Households | 19.8% | 18.6% | 18.7% |
| 4 Person Households | 18.9% | 17.8% | 17.9% |
| 5 Person Households | 9.3% | 8.5% | 8.6% |
| 6 Person Households | 3.3% | 2.6% | 2.6% |
| 7 + Person Households | 1.8% | 2.2% | 2.1% |

Housing Value & Rental Costs

| | | | |
|-------------------------------------|-----------|-----------|-----------|
| Median Owner-Occupied Housing Value | \$182,582 | \$175,453 | \$183,551 |
| Average Monthly Contract Rent | \$786 | \$760 | \$769 |

Housing Units - Year Moved In

| | | | |
|-----------------|------|------|------|
| 1969 or earlier | 1.1% | 2.9% | 2.9% |
| 1970 to 1979 | 5.0% | 6.8% | 8.0% |

| | | | |
|----------------------------|-------|-------|-------|
| 1980 to 1989 | 16.0% | 14.8% | 15.6% |
| 1990 to 1994 | 20.2% | 19.5% | 19.3% |
| 1995 to 1998 | 34.9% | 33.3% | 32.5% |
| 1999 to 2000 | 22.9% | 22.7% | 21.8% |
| Housing Stability (5 Year) | 42.1% | 43.6% | 45.0% |
| Housing Turnover (1 Year) | 23.1% | 23.0% | 22.1% |

Demographic Snapshot Summary

Geography: 5 Miles: 2050 NUT TREE RD VACAVILLE, CA 95687

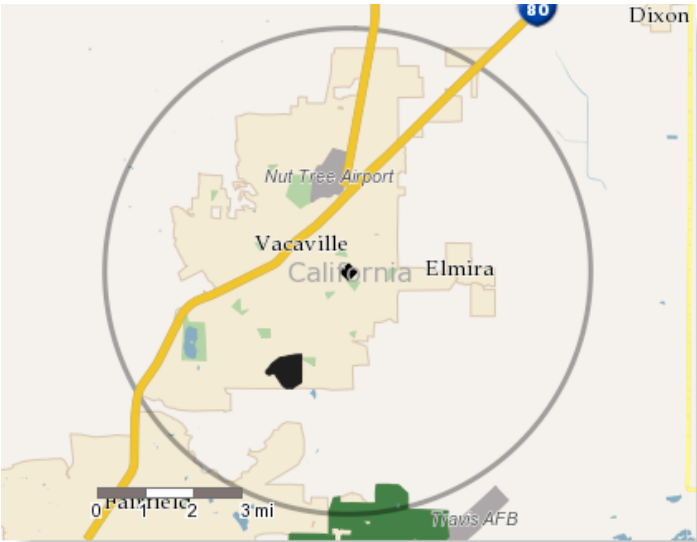

©2009 Tele Atlas

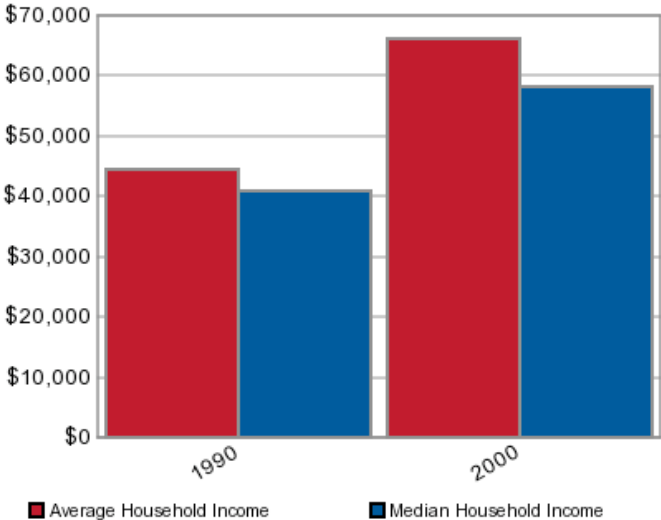

| Population Summary | | | | Household Summary | | | |
|--------------------|--------|--------|----------|-------------------|----------|----------|----------|
| | 1990 | 2000 | % Change | | 1990 | 2000 | % Change |
| Total Population | 76,158 | 94,288 | 23.8% | Total Households | 24,302 | 30,216 | 24.3% |
| Female Population | 45.0% | 46.0% | 2.2% | Average Income | \$14,510 | \$66,137 | 355.8% |
| Male Population | 55.0% | 54.0% | -1.8% | Median Income | \$40,933 | \$58,275 | 42.4% |
| Median Age | 30.9 | 34.0 | 10.0% | Per Capita Income | \$14,510 | \$21,194 | 46.1% |

If you are looking for more current demographic data, DemographicsNow provides quarterly population estimates, current year estimates and 5 year population projections. Go to www.demographicsnow.com